

SKIPPER



ELETTROPOMPE SOMMERGIBILI VORTEX PER ACQUE CARICHE SUBMERSIBLE VORTEX ELECTRIC PUMPS FOR WASTEWATER

PREVALENZA : 7,5 mt. ÷ 13 mt.
PORTATA : 15,6 m³/h ÷ 30 m³/h
POTENZA NOMINALE : 0,6 Kw (0,8HP) ÷ 1,5 Kw (2HP)
PASSAGGIO SOLIDI FINO A 50 mm.

APPLICAZIONI

- SVUOTAMENTO DI FOSSE DI DECANTAZIONE, POZZI NERI, POZZI DI RACCOLTA LIQUAMI.
- POMPAGGIO DI ACQUE LURIDE ANCHE CON CORPI SOLIDI IN SOSPENSIONE.
- MOVIMENTAZIONE DI ACQUE LURIDE AD USO DOMESTICO ED INDUSTRIALE.

PUMP HEAD : 7.5 m to 13 m
DELIVERY : 15.6 m³/h to 30 m³/h
RATED HORSEPOWER : 0.6 kW (0.8HP) to 1.5 kW (2HP)
SOLID MATTER BYPASS up to 50 mm

APPLICATIONS

- DECANTATION PIT, SEWAGE PIT AND SLURRY COLLECTION PIT PUMP OUT.
- PUMP OUT OF LAVATORY/FOUL WATER WITH POSSIBLE FLOATING SOLIDS CONTENTS.
- DOMESTIC AND INDUSTRIAL LAVATORY/BLACK WATER HANDLING SYSTEMS.

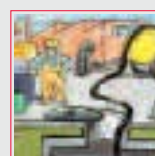
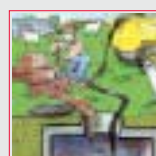
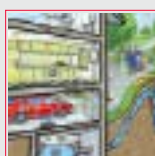

CARATTERISTICHE DI COSTRUZIONE:

- ELETTOPOMPA A DOPPIA CAMERA (MOTORE, TENUTA MECCANICA).
- MOTORE A BAGNO D'OLIO (BIODEGRADABILE E DIELETTRICO) PER RAFFREDDAMENTO E LUBRIFICAZIONE CUSCINETTI.
- ANELLO DI TENUTA LATO MOTORE.
- TENUTA MECCANICA A BAGNO D'OLIO.
- IMMERSIONE MASSIMA: mt. 5 .
- GRADO DI PROTEZIONE IP 68 .
- CLASSE DI ISOLAMENTO: F
- TEMPERATURA MAX. LIQUIDO POMPATO:
25°C con pompa PARZIALMENTE immersa.
50°C con pompa TOTALMENTE immersa.
- PASSAGGIO LIBERO: 35 mm. - SKIPPER 80
50 mm. - SKIPPER 100 - 150 - 200
- VERSIONI: Monofase: 220 - 230V/50Hz e 220 - 230V / 60 Hz con protettore termico incorporato e condensatore permanentemente inserito.
Trifase: 220 - 230V/50Hz o 380 - 400V / 50Hz e 220-230V o 380 - 400V / 60Hz con protezione da sovraccarico a cura dell'utente.
- VERSIONI MONOFASI AUTOMATICHE CON GALLEGGIANTE O MANUALI SENZA GALLEGGIANTE.
- CAVO STANDARD:
Monofase: 10 metri H07RN-F per versione normale (aut.-man.)
5 metri H07RN-F solo per versione automatica. (esclusa SKIPPER 150)
Trifase:10 metri H07RN-F
- SPECIALI VOLTAGGI E FREQUENZE A RICHIESTA.

DESIGN ENGINEERING:

- DOUBLE CHAMBER ELECTRIC PUMP (MOTOR, MECHANICAL SEAL).
- OIL BATH MOTOR (BIODEGRADABLE AND DIELECTRIC) FOR COOLING AND BEARING LUBRICATION.
- SEALING RING - ENGINE FACE.
- OIL BATH MECHANICAL SEALS.
- PERMISSIBLE DRAUGHT OF WATER: 5 m
- IP 68 PROTECTION CLASS.
- CLASS "F" INSULATION.
- MAX. PUMPED LIQUID TEMPERATURE:
25°C with PARTIALLY submerged pump.
50°C with TOTALLY submerged pump.
- BY PASS SECTION: 35 mm. - SKIPPER 80
50 mm. - SKIPPER 100 - 150 - 200
- VERSIONS: Single Phase: 220 - 230 V / 50 Hz or 220 - 230V / 60 Hz with built in thermal protection and permanent capacitor.
Three Phase :220 - 230 V / 50 Hz or 380 - 400V / 50Hz and 220-230V or 380 - 400V / 60Hz with overload protection care of the User
- AUTOMATIC SINGLE PHASE VERSIONS WITH FLOATER OR MANUAL SINGLE PHASE VERSIONS, WITHOUT FLOATER.
- STANDARD CABLE FEATURES:
Single Phase:10 metres H07RN-F for the standard version (automatic-manual)
5 metres H07RN-F only for the automatic version (excluded SKIPPER 150).
Three Phase: 10 metres H07RN-F
- CUSTOMISED VOLTAGE AND FREQUENCY RATING AVAILABLE ON DEMAND.

TABELLA MATERIALI / MATERIALS TABLE:

Pos.	Componente / Component		Materiale / Materials
A	Carcassa esterna / External housing		ACCIAIO INOX AISI 304 - DIN 1.4301 STAINLESS STEEL
B	Girante / Impeller		
C	Albero (lato pompa) / Shaft (pump side)		ACCIAIO INOX AISI 316 - DIN 1.4401 STAINLESS STEEL
D	Tenuta meccanica Mechanical seal	Lato pompa / Pump side	CARBURO DI SILICIO-ALLUMINA SILICON CARBIDE-ALUMINA
		Lato motore / Motor side	ANELLO DI TENUTA NBR NBR SEAL RING
E	O-ring		NBR
G	Porta motore / Motor holder		ACCIAIO INOX AISI 304 - DIN 1.4301 STAINLESS STEEL
I	Coperchio + maniglia / Cover + handle		
N	Base d'appoggio / Base holder		
P	Corpo pompa / Pump body		

SKIPPER 80 - 100 - 150 - 200

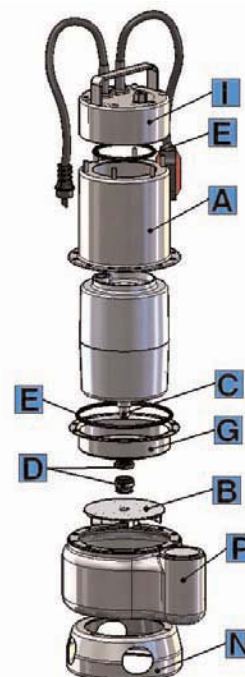

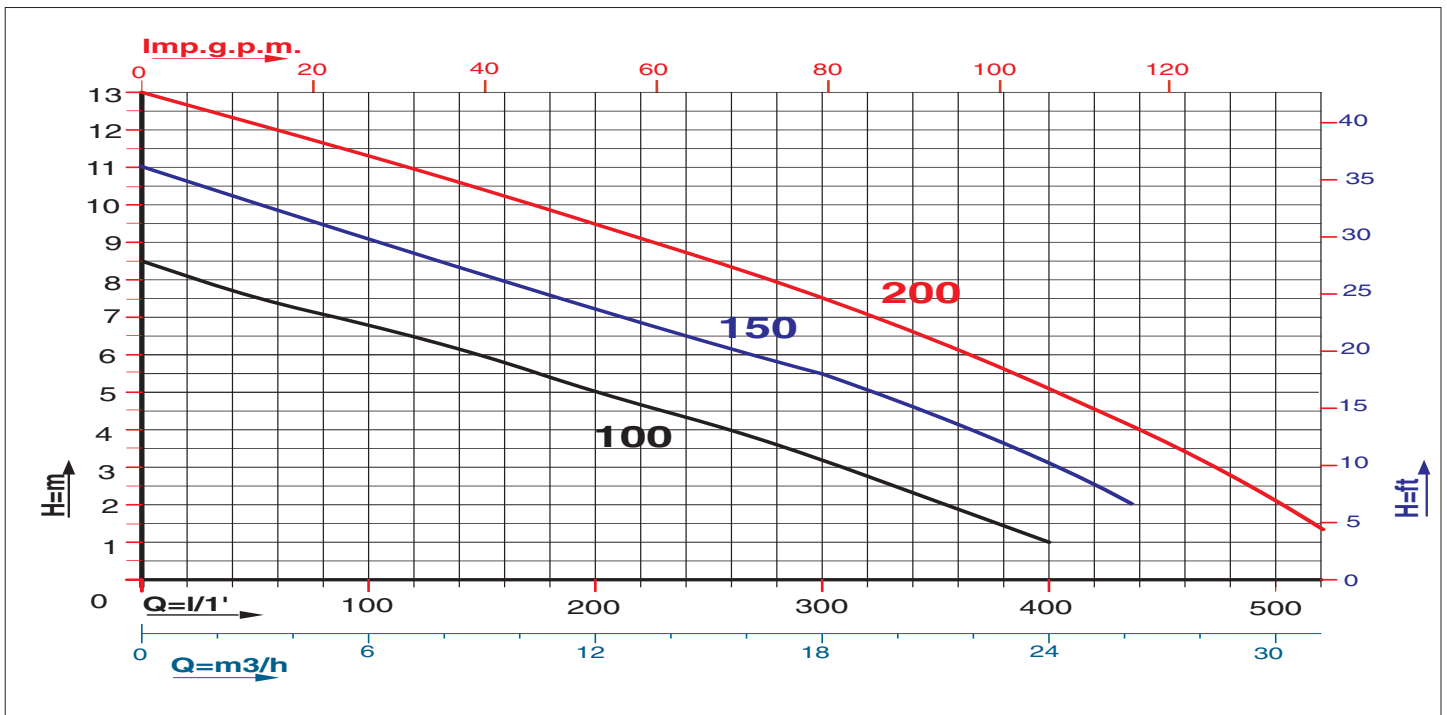
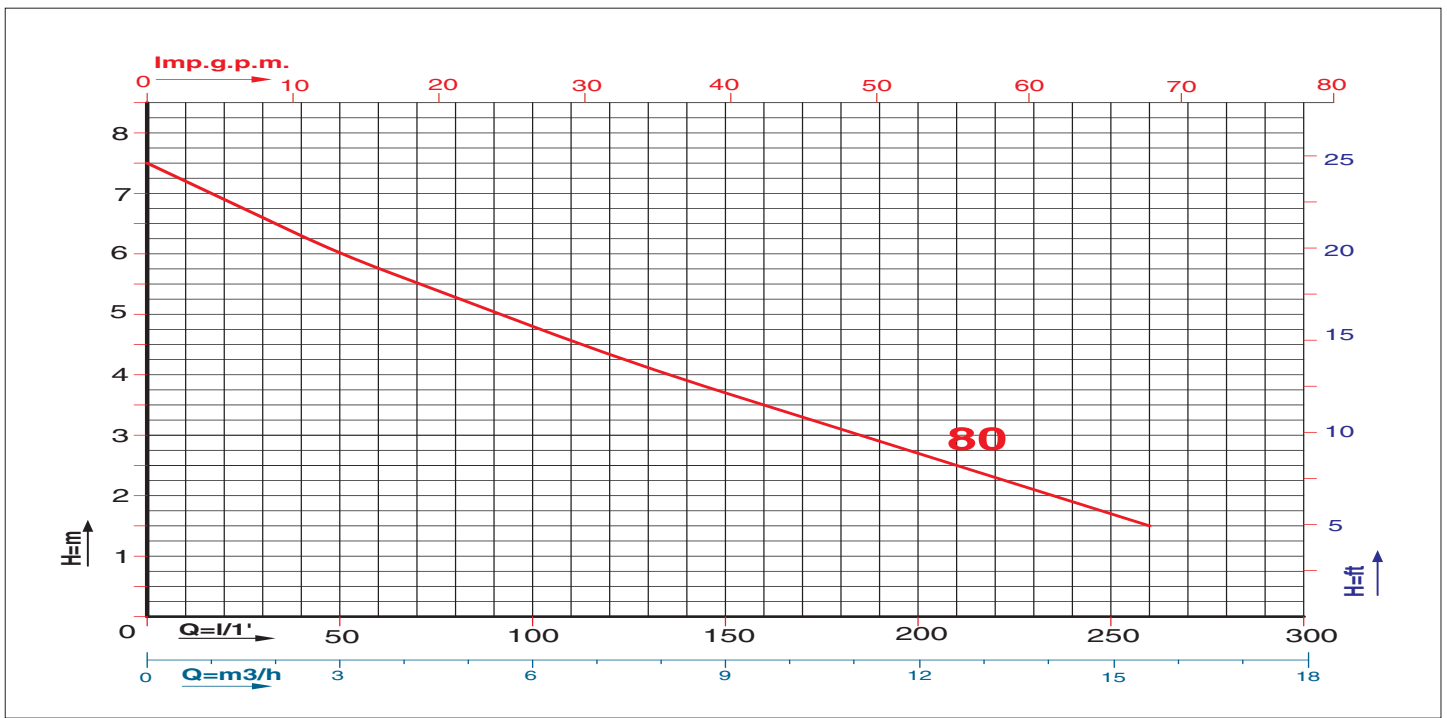

Caratteristiche di funzionamento a 2800 rpm 50Hz e 3450 rpm 60Hz - Performances at 2800 rpm 50 Hz and 3450 rpm 60 Hz
 Le prestazioni valgono per liquidi con densità $\rho = 1,0 \text{ kg/dm}^3$ ed una viscosità $\nu = 1 \text{ mm}^2/\text{s}$ / The performance data holds true for liquids with a $\rho = 1,0 \text{ kg/dm}^3$ density and a $\nu = 1 \text{ mm}^2/\text{s}$ viscosity.

MODELLO MODEL	VOLTAGGIO VOLTAGE 50 Hz	DATI ELETTRICI / ELECTRICAL DATA						DATI IDRAULICI / HYDRAULIC DATA																					
		P1 max		P2 nom.		I max	Condensatore Capacitor		H (m)																				
		Kw	Kw	HP	Ampere	μF	VC	m³/h	0	3	6	9	12	15,6	18	24	27	30	l/min.	0	50	100	150	200	260	300	400	450	500
SKIPPER 80 M	1 x 220-230V	1,1	0,6	0,8	5,0	16	450																						
SKIPPER 80 T	3 x 380-400V	0,9	0,6	0,8																									
SKIPPER 100 M	1 x 220-230V	1,5	0,75	1	6,5	20	450																						
SKIPPER 100 T	3 x 380-400V	1,3	0,75	1	2,4	---	---																						
SKIPPER 150 M	1 x 220-230V	2,2	1,1	1,5	10,4	30	450																						
SKIPPER 150 T	3 x 380-400V	1,7	1,1	1,5	3,0	---	---																						
SKIPPER 200 T	3 x 380-400V	2,2	1,5	2	3,6	---	---																						

DIMENSIONI e PESI / SIZE AND WEIGHT DATA:

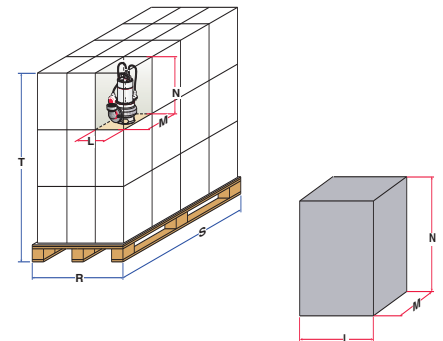
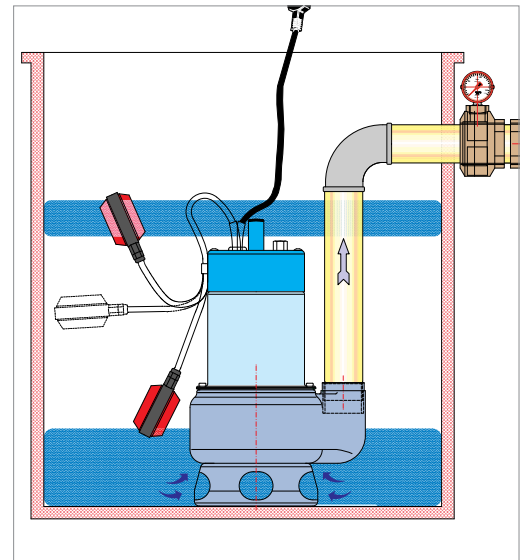
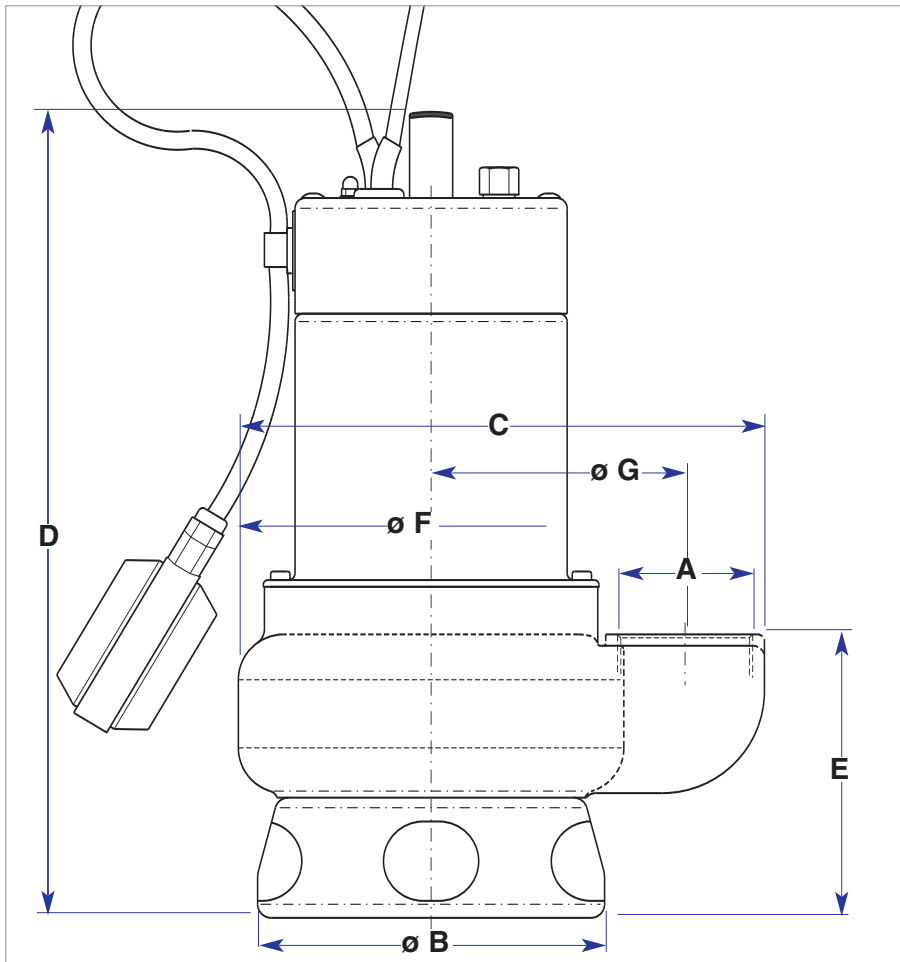

MODELLO / MODEL	DIMENSIONI POMPA in mm. / PUMP DIMENSIONS in mm.								
	A	B	C	D	E	F	G	H	I
SKIPPER 80 M	1 1/2"	164	217	355	153	164	108		
SKIPPER 80 T	1 1/2"	164	217	355	153	164	108		
SKIPPER 100 M	2"	164	221	355	178	164	108		
SKIPPER 100 T	2"	164	221	355	178	164	108		
SKIPPER 150 M	2"	164	221	395	178	164	108		
SKIPPER 150 T	2"	164	221	395	178	164	108		
SKIPPER 200 T	2"	164	221	395	178	164	108		

MODELLO / MODEL	DIMENSIONI SCATOLA / PACKING DIMENSIONS				DIMENSIONI PALLET / PALLET DIMENSIONS				
	L mm.	M mm.	N mm.	Peso / Weight Kg.	R mm.	S mm.	T mm.	nr. scatole/cartons	Peso / Weight Kg.
SKIPPER 80 M	190	230	410	10,5	800	1200	1360	60	650
SKIPPER 80 T	190	230	410	10,5	800	1200	1360	60	650
SKIPPER 100 M	190	230	410	11,5	800	1200	1360	60	715
SKIPPER 100 T	190	230	410	11,5	800	1200	1360	60	715
SKIPPER 150 M	190	230	410	13,5	800	1200	1360	60	835
SKIPPER 150 T	190	230	410	13,5	800	1200	1360	60	835
SKIPPER 200 T	190	230	410	13,5	800	1200	1360	60	835