

Helical Rotor Pumps

Pompe a Rotore Elicoidale

SYDEX
pump

Sydex Srl

Via Lord Baden Powell, 24

36045 Lonigo (Vicenza) - ITALY

Tel. +39 0444 43 25 88

Fax +39 0444 43 25 89

Web site: www.sydexpump.com

E-mail: info@sydexpump.com

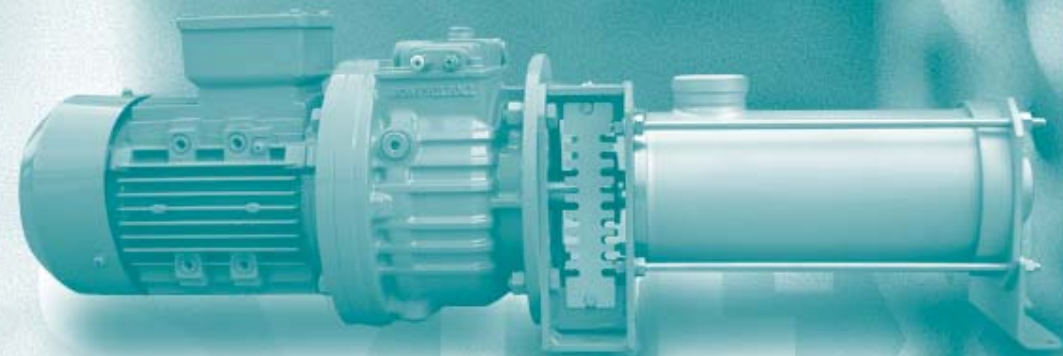

SYDEX
pump



Your authorized Sydex distributor is:

Pompe a Rotore Elicoidale - Helical Rotor Pumps

Tipo - Range "FM"

Le pompe della serie "FM" a statore flottante, compatte e versatili, permettono di ottenere tutti i vantaggi di una pompa a cavità progressive con un ingombro limitato e con costi di manutenzione e d'acquisto convenienti.

Caratteristiche:

- Diversi modelli disponibili con portate da 20 fino a 10.000 l/h
- Autoadescanti ad alta efficienza
- Compatte e leggere
- Bassa rumorosità
- Pulsazioni praticamente assenti.
- Costi di manutenzione e d'acquisto molto competitivi
- Diversa scelta di materiali costruttivi.

Alcune applicazioni:

- Trattamento acque residuali (Dosaggio Polimeri, Flocculanti, Fanghi, Acqua piovana, ecc.)
- Industria Chimica (Detergenti, Vernici, Inchiostri, Colle, Soda, ecc.)
- Costruzione (Cemento, Bentonite, Malte, ecc.)
- Industria Agro-alimentare (Trasferimento olio, vino, succhi, creme, emulsioni, ecc.)
- Energia (Idrocarburi)
- Forniture Navali (impianti per separazione acqua olio, svuotamento sentina e gabinetti, ecc)

Compact and versatile, the FM range brings you all the advantages of progressing cavity pumps, in a small, compact and economical design.

Testen and proven in many applications:

- Wide range of flows 20 up to 10,000 LPH
- High performance combined with efficient design
- Self priming ideal for suction lifts
- Lightweight and compact
- Low noise emissions
- Non-pulsating reliable flow
- Extremely simple maintenance
- Low cost of ownership
- Different material combinations available to suit applications.

Applications:

- Waste water treat (Polymers, waste, sludge, flocculants)
- Chemical industry (detergents, varnish, paints, inks, soaps)
- Buildings (Cements, Bentonite)
- Agrofood industry (Creams, emulsions, wine, olive oils)
- Energy (Hydrocarbons, coolant and cutting oils, acids)
- Drainage applications
- Sampling duties
- Abrasive slurries
- Ideal for OEM pump applications

Tipo - Size FMC 036/074/154/253

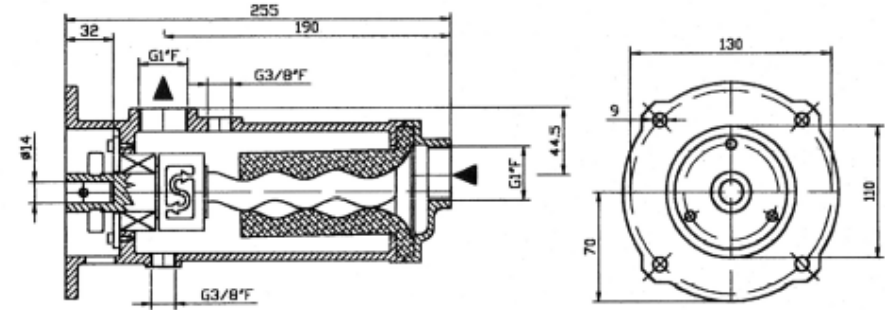

PRESTAZIONI TEORICHE - THEORETICAL PERFORMANCES

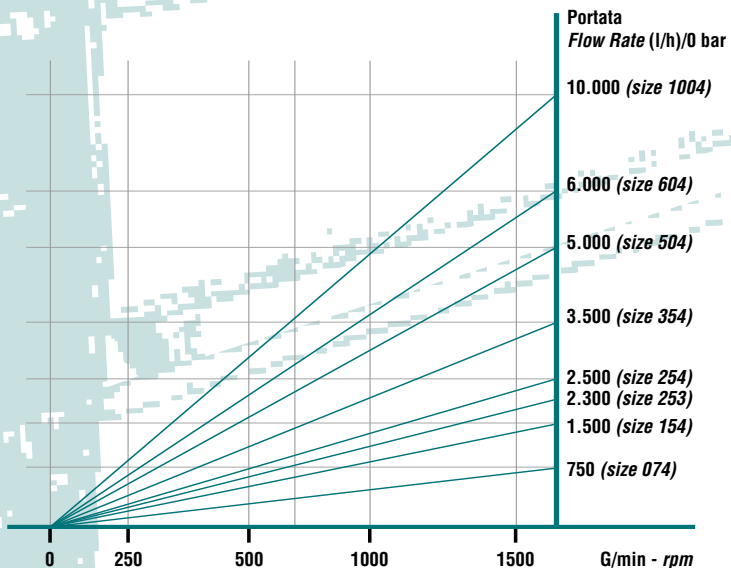

Tipo - Size FMS 254/354/504/604/1004

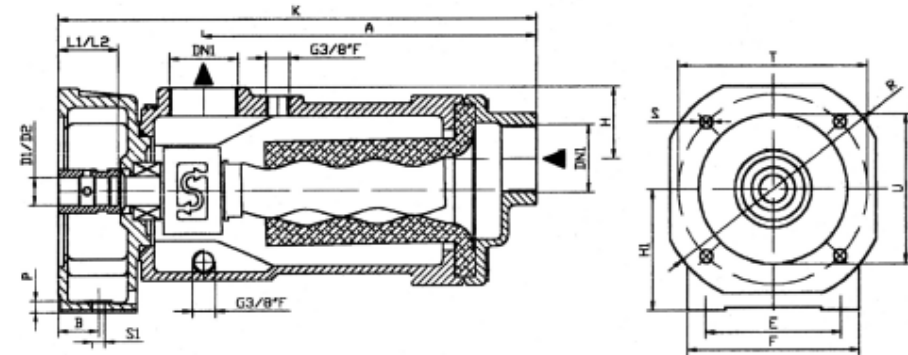

TIPO/SIZE	A	B	D1	D2	DN1	E	F	H	H1	K	L1	L2	P	R	S	S1	T	U	Kg.
FMS 25/4	248	35	19	24	G1 1/2" F	118	150	61	105	368	47	52	10	200	11	11	165	130	16
FMS 35/4	248	35	19	24	G1 1/2" F	118	150	61	105	368	47	52	10	200	11	11	165	130	16,5
FMS 50/4	286	35	19	24	G 2" F	118	150	63	105	412	47	52	10	200	11	11	165	130	20
FMS 60/4	286	35	19	24	G 2" F	118	150	63	105	412	47	52	10	200	11	11	165	130	20,5
FMS 100/4	286	35	-	24	G 2" F	160	200	63	130	422	-	52	10	200	11	11	165	130	24