

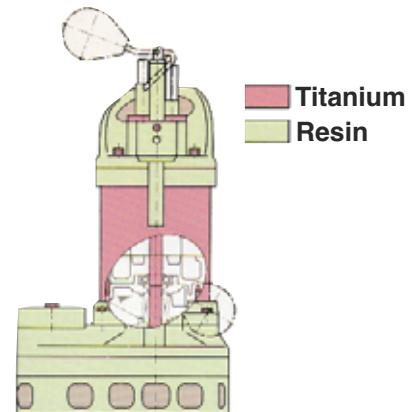

Tsurumi TM

230V
400V
50Hz

Submersible Titanium Seawater Pumps

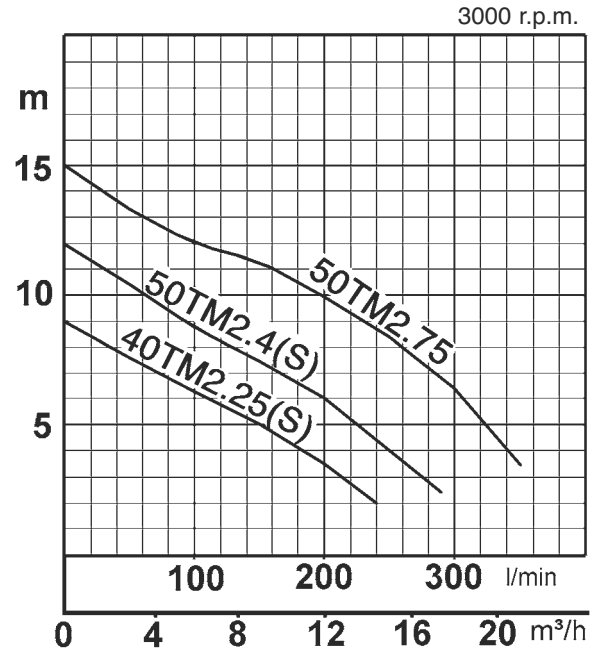

Titanium is used in all the wet metal parts of the TM pumps. Titanium has a far stronger oxide film on its surface than stainless steel does. This prevents the pumps from being corroded in the seawater which has a very high chlorine ion concentration.

Resistant to corrosion



Discharge bore mm		40	50	TM
Pumping Fluid	Type of Fluid	Seawater		
	Liquid Temperature	0 - 40°C		
Pump	Components	Impeller	Vortex	
		Shaft Seal	Double mechanical seal	
		Bearing	Shielded ball bearings	
	Material	Impeller	Resin with glass fibre	
		Lower Casing	Resin with glass fibre	
		Upper Casing	Resin with glass fibre	
	Shaft Seal (mechanical Seal)	Silicon carbide in oil bath		
Motor	Type, Poles	Dry-type submersible induction motor, 2 poles, IP68		
	Insulation	Insulation class E		
	Phase / Voltage	Single-phase / 230V Three-phase / 400V		
	Motor Protector (built-in)	Circle thermal protector		
	Lubricant	Liquid paraffin (ISO VG15)		
	Material	Frame	Titanium	
		Shaft	Titanium	
Cable		Rubber, H07RN-F		
Discharge Connection		Special flange		



Cleaning the deck of a fishing boat.



Supplying seawater to a prawn farm.



Circulating seawater in the reserve of a crab dealer

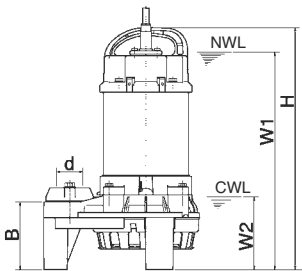
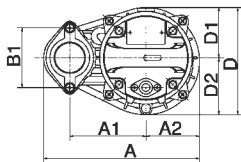

CWL: continuous operation water level
NWL: lowest operation water level

Dimensions: Unit mm

Model	d	A	A1	A2	B	B1	D	D1	D2	H	W1	W2
40TM2.25S	40	236	115	81	102	90	162	76	86	360	325	110
40TM2.25	40	236	115	81	102	90	162	76	86	349	310	110
50TM2.4S	50	236	115	81	102	90	162	76	86	360	325	110
50TM2.4	50	236	115	81	102	90	162	76	86	360	325	110
50TM2.75	50	236	115	81	102	90	162	76	86	374	335	110

Specifications:

Bore mm	Model	Output kW	Phase	Total Head max.m	Capacity max. l/min	Starting method	Dry Weight kg	Impeller passage dia. mm	Cable m
40	40TM2.25S	0,25	Single	9,0	200	Condenser	6,7	10	10
40	40TM2.25	0,25	Three	9,0	200	D.O.L.	5,7	10	10
50	50TM2.4S	0,4	Single	12,0	290	Condenser	6,7	10	10
50	50TM2.4	0,4	Three	12,0	290	D.O.L.	6,6	10	10
50	50TM2.75	0,75	Three	15,0	300	D.O.L.	7,8	10	10

Dry weight of the pump excluding cable

We reserve the right to change specifications and designs herein for improvement without prior notice. Our pumps are for professional use only. In the event that Tsurumi (Europe) GmbH have, in exceptional cases taken over, a manufacturer's warranty, this entitles the end-user to assert remedy free of charge against Tsurumi (Europe) GmbH due to any defect to the product occurring during the guarantee period (see below), also then when the warranty claims against the seller do not or no longer exist. In the event of malfunction, which is attributable to the improper handling by the enduser, no guarantee claim shall arise. Further claims shall not result from the warranty, unless if something to the contrary has explicitly been determined. The decision as to whether remedy is effected by way of replacement or repair shall be at the choice of Tsurumi (Europe) GmbH. The claims shall be time barred after a period of three months after expiry of the guarantee period, however, not before expiry of the warranty period which is valid towards the seller. In the event of doubt, the warranty period shall correspond with the warranty period which is valid between the end-user and his seller.

Tsurumi (Europe) GmbH

Heltorfer Straße 14
D-40472 Düsseldorf
Tel.: +49-211-4179373
Fax: +49-211-4791429
Email: sales@tsurumi-europe.com
www.tsurumi-europe.com

Your Dealer