FEKA 1400 - 1800

SUBMERSIBLE PUMPS FOR CESSPOOLS



GENERAL DATA

Applications

Submersible cast iron pump with vortex backflowing impeller for cesspools. Suitable for lifting or drainage installations for sewage from cesspools and for generally dirty water containing solids up to maximum 38 mm diameter. Also suitable for ground water, rain water, clean and dirty waste water, river or lake water.

Constructional features of the pump

Cast iron pump body, motor casing, suction cover and impeller.

Stainless steel rotor, handle and screws.

Inspectable oil seal chamber.

Carbon/ceramic mechanical seal.

The supply vent of 2" threaded GAS is radial to facilitate assembly on the lifting devices (DSD 2).

Constructional features of the motor

Continuous duty submersible induction motor, in a watertight casing.

Rotor mounted on oversized greased sealed-for-life ball bearings.

Thermal protection in the windings, to be connected to the control panel.

In order to operate, the pumps must be equipped with a control and protection system, supplied separately and not connected to the electropumps.

Supplied with 10 metres of neoprene rubber power cable 6x(4x1,5)+(2x0,5).

Motor protection: IP68

Insulation class: F

Manufactured according to CEI 2-3 standards.

Standard voltage:	single-phase	220-240 V/50 Hz
	three-phase	400 V/50 Hz

TECHNICAL DATA

N.	PARTS*	MATERIALS
1	PUMP BODY	CAST IRON 200 UNI ISO 185
4	IMPELLER	CAST IRON 200 UNI ISO 185
7	MOTOR SHAFT	STAINLESS STEEL AISI 416 X12CrS13 - UNI 6900/71
10	MOTOR CASING	CAST IRON 200 UNI ISO 185
16	MECHANICAL SEAL	CARBON/CERAMIC
28	OR GASKET	VITON
29	OR GASKET	VITON
35	SUCTION COVER	CAST IRON 200 UNI ISO 185
77	PROTECTION COVER	CAST IRON 200 UNI ISO 185
120	HANDLE	STAINLESS STEEL AISI 304 X5CrNi 1810 - UNI 6900/71

* In contact with the liquid

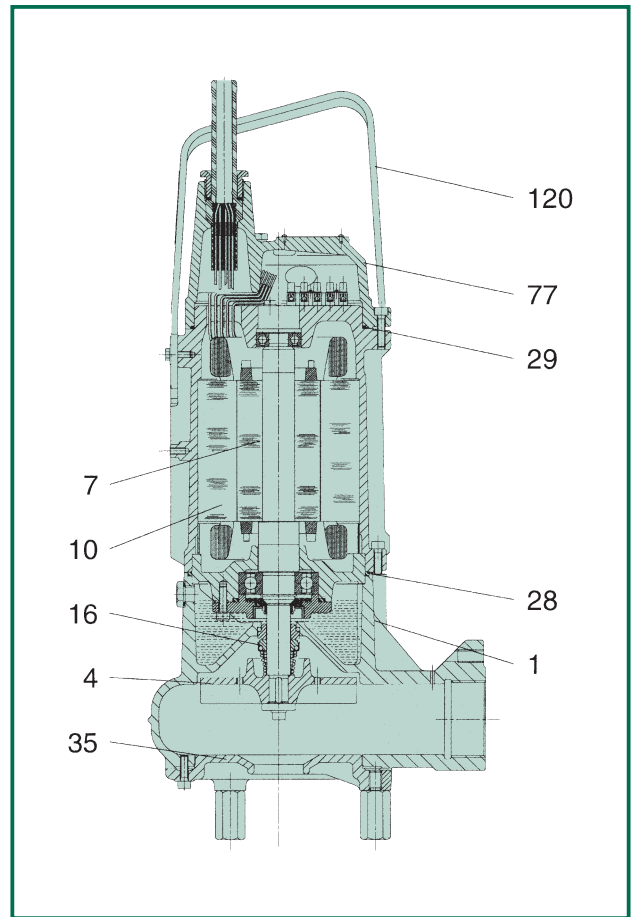

- Operating range: from 6 to 30 m³/h with head up to 14 metres for the single-phase version and 15,5 metres for the three-phase version.
- Liquid quality requirements: dirty waste water, untreated sewage containing solids, always non aggressive
- Liquid temperature range: from 0°C to +55°C
- Maximum ambient temperature for pump operation with the motor emerging: +40°C
- Free passage of solids: 38 mm
- Maximum immersion depth: 10 metres
- Installation: fixed or portable in a vertical position
- Special executions on request: other voltages and/or frequencies

The performance curves are based on the kinematic viscosity values = 1 mm²/s and density equal to 1000 kg/m³. Curve tolerance according to ISO 9906.

Liquid temperature range: from 0°C to +55°C

FEKA 1400 - 1800

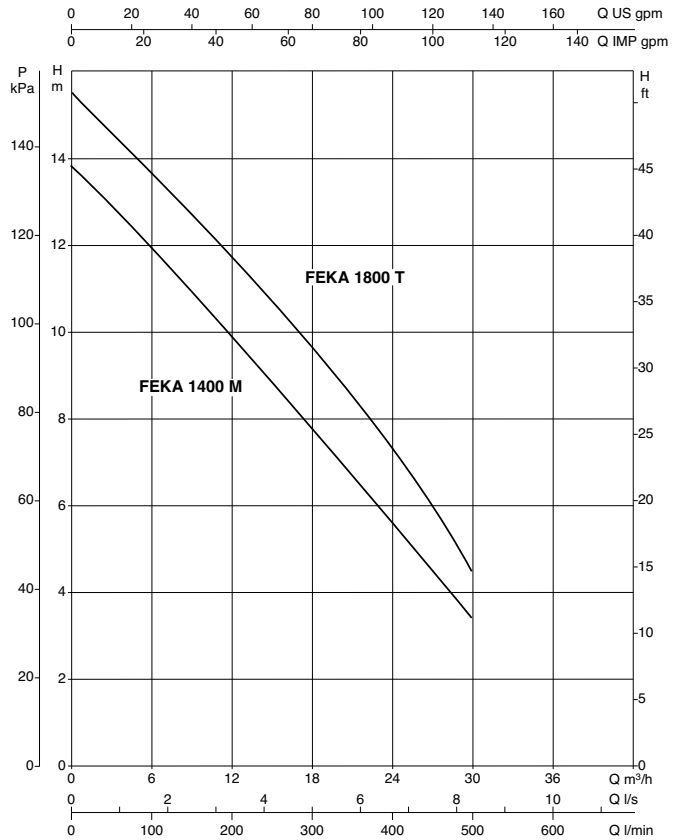
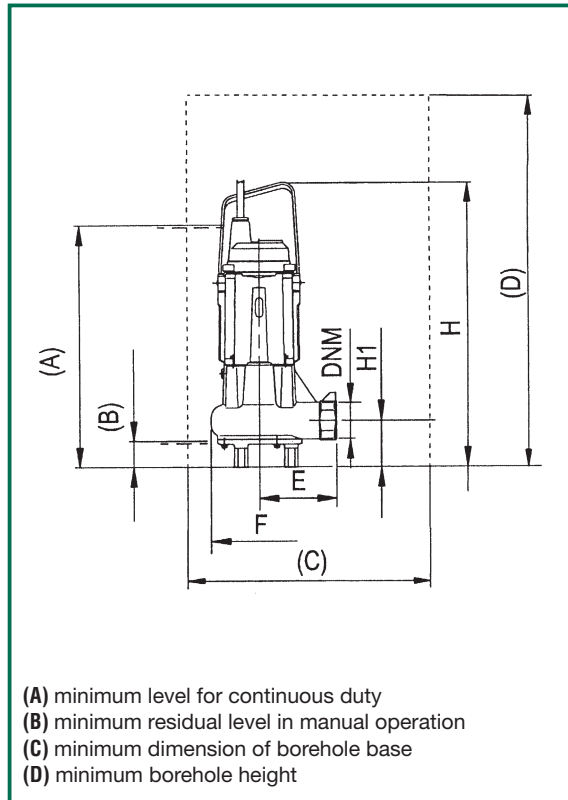

MODEL	A	B	C	D	E	F Ø	DNM	H	H1	PACKING DIMENSIONS			VOLUME m ³	WEIGHT Kg
										L/A	L/B	H		
FEKA 1400 M	500	50	500x500 min	600 min	160	200	2" G	583	94	680	330	380	0,085	41,2
FEKA 1800 T	500	50	500x500 min	600 min	160	200	2" G	583	94	680	330	380	0,085	42,4

MODEL	ELECTRICAL DATA						HYDRAULIC DATA (n = 2800 1/min)							
	VOLTAGE 50 Hz	P1 MAX kW	P2 NOMINAL		In A	CAPACITOR		Q m ³ /h l/min	0	6	12	18	24	30
			kW	HP		µF	Vc							
FEKA 1400 M	1x220-240 V ~	1,8	1,1	1,5	8,5	40	450	H (m)	13,9	12	9,9	7,8	5,7	3,4
FEKA 1800 T	3x400 V ~	1,9	1,5	2	3,7	-	-		15,5	13,7	11,8	9,7	7,3	4,5