

NM End Suction Centrifugal Pumps

Performance Curves 50 Hz

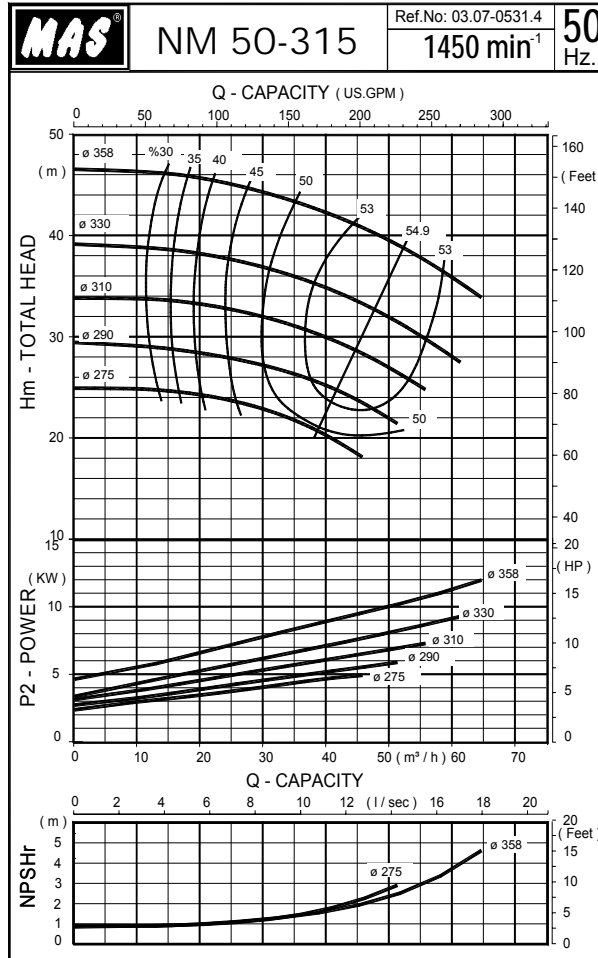

The Performance Curves 50 Hz are based on the kinematic viscosity 1 mm²/s and density 1g/cm³. Tolerances are acc. to ISO 9906 Annex A.

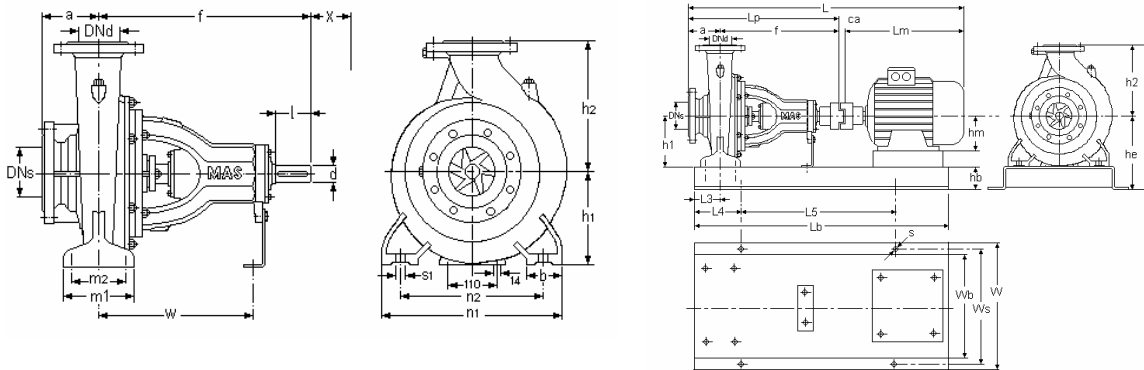

Pump size	Flanges		Length		Height		Mounting details							Shaft end		(*) X	Weight kg
	DNs	DNd	a	f	h1	h2	b	m1	m2	n1	n2	s1	W	d	l		
50-315	80	50	100	470	225	280	80	160	120	360	280	M16	330	32	80	100	103

	MOTOR			PUMP		GENERAL				BASEPLATE									
	KW	IEC	Lm	Hm	Lp	Ca	L	W	H	Lb	Wb	Hb	He	L3	L4	L5	Ws	S	Plate No
50-315 4poles 50Hz	4	112M	384	112	593	21	1000	490	585	900	380	80	305	72	150	600	440	24	6.04
	5,5	132S	455	132	595	26	1076	490	585	1000	380	80	305	72	170	660	440	24	6.05
	7,5	132M	493	132	595	26	1114	490	585	1000	380	80	305	72	170	660	440	24	6.05
	9	C132M	493	132	595	26	1114	490	585	1000	380	80	305	72	170	660	440	24	6.05
	11	160M	593	160	595	30	1219	490	585	1120	380	80	305	72	190	740	440	24	6.06

MAS Pompa reserves the right to change specifications without prior notice.