

NM End Suction Centrifugal Pumps

Performance Curves 50 Hz

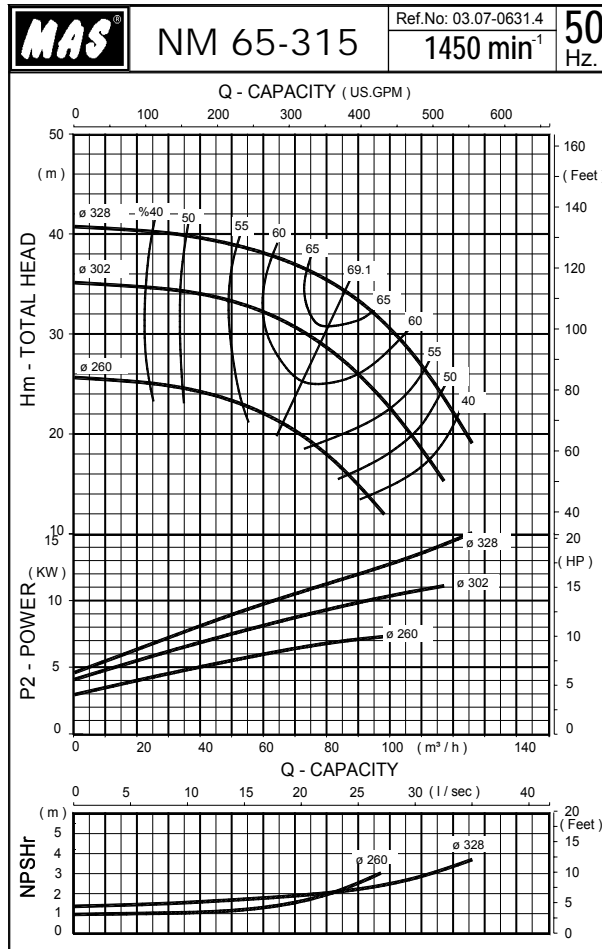

The Performance Curves 50 Hz are based on the kinematic viscosity 1 mm²/s and density 1g/cm³. Tolerances are acc. to ISO 9906 Annex A.

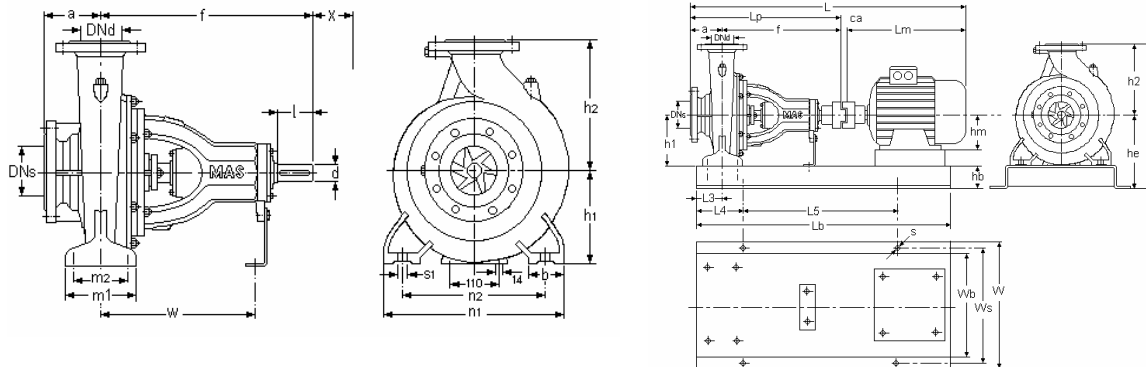

Pump size	Flanges		Length		Height		Mounting details							Shaft end		(*) X mm	Weight kg
	DNs mm	DNd mm	a mm	f mm	h1 mm	h2 mm	b mm	m1 mm	m2 mm	n1 mm	n2 mm	s1 mm	W mm	d mm	l mm		
65-315	80	65	125	470	225	280	80	160	120	400	315	M16	340	32	80	110	92

	MOTOR			PUMP		GENERAL				BASEPLATE									
	KW	IEC	Lm mm	Hm mm	Lp mm	Ca mm	L mm	W mm	H mm	Lb mm	Wb mm	Hb mm	He mm	L3 mm	L4 mm	L5 mm	Ws mm	S mm	Plate No
65-315 4 poles 50Hz	7,5	132M	493	132	595	26	1114	540	585	1000	430	80	305	90	170	660	490	24	7,05
	9	C132M	493	132	595	26	1114	540	585	1000	430	80	305	90	170	660	490	24	7,05
	11	160M	594	160	595	30	1219	540	585	1120	430	80	305	90	190	740	490	24	7,06
	15	160L	630	160	595	30	1263	540	585	1120	430	80	305	90	190	740	490	24	7,06

MAS Pompa reserves the right to change specifications without prior notice.